

Existing First Floor Plan

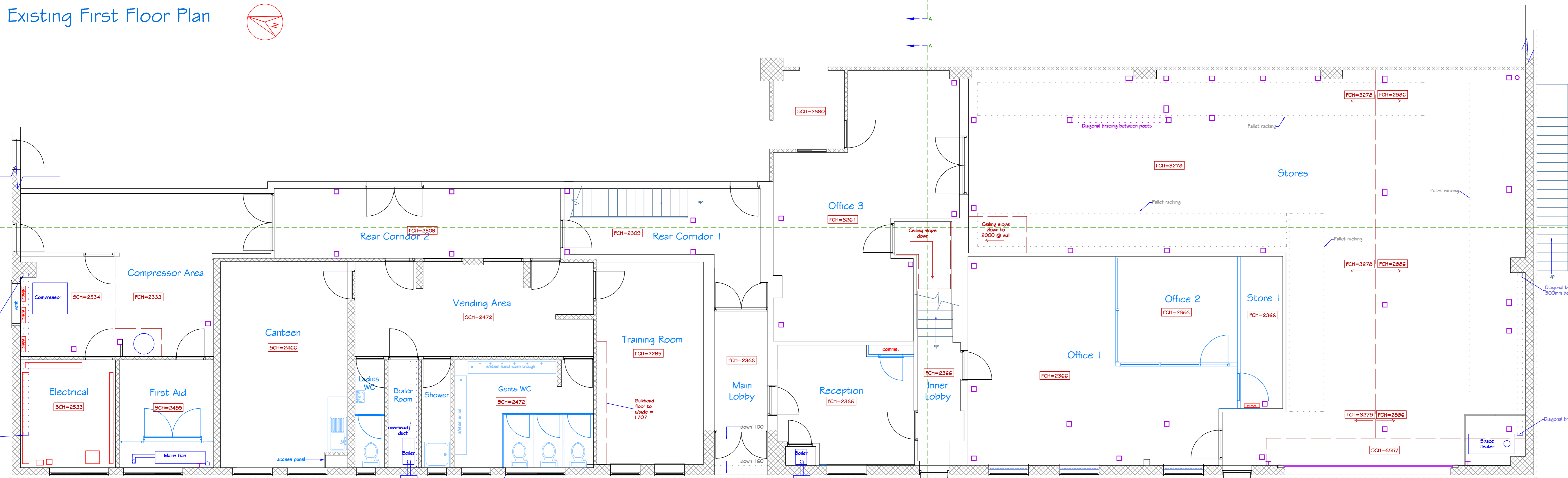

Existing Ground Floor Plan

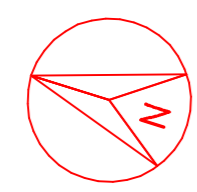
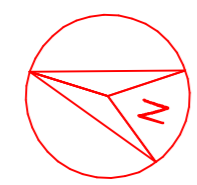

Legend and Notes

- = Demountable Partition, Full Height
- = Demountable Partition, Half Height
- = Studwork or plasterboard cladding
- = Block or Brck
- = Steel Posts

FCH = False Ceiling Height - Suspended ceiling in gnd.
 SCH = Structural Ceiling Height - Plasterboard on joists.

Notes: Ceiling and wall construction types indicated are assumed from visual inspection, it is possible that structure may be concealed behind 'false' ceilings and wall claddings and this should be verified prior to embarking on any works reliant on any such indications. In particular some walls marked as clad could be concealing structure and some stud walls may be performing as structural elements.

In some parts of the building access was restricted by considerable amounts of pallet racking, heavy goods, plant or equipment. Whilst every effort has been made to measure accurately all dimensions should be checked on site prior to making final decisions regarding revisions to the layout.

Major incoming electrical and gas services are indicated generally and where visible, they are not drawn in detail and other incoming mains services may be present.

Pallet racking positions are indicative only and this has not been measured.

Also refer to drawing 61767/03

Property Address:	Drawing Title: Existing Floor Plans Front Part of the Building	Revisions: A: 06/10/2010 - Note added re. no access to void adjacent to first floor Stores room.
Floor Areas in Square Metres: Ground = 448, First 443, Total = 892 (BQ) square feet	Scale: A0 sized drawing: 1: 50 Unless Otherwise Stated	
FLOORPLANZ © 2009 01483 755510 Ref: 1767/02		Any queries regarding this plan should be in the first instance be referenced back to FLOORPLANZ for clarification. Do not photocopy or reduce this plan as the scale may be affected.